

IM
2007
Moving from Bits
to Business Value

21–25 May 2007
Munich, Germany



10th IFIP/IEEE Symposium on Integrated Management

General Information

Address:

Universität der Bundeswehr München
Werner-Heisenberg-Weg 39
85579 Neubiberg
Germany

Contact during conference:

+49 151 50002047

Important facilities:

Main entrance of the university:

The main entrance for all conference attendees is “Nordtor” in the north of the campus in front of building 36 (see plans). All conference attendees arriving by car enter through “Westtor”. Please bring your badge with you!

Conference building:

Building 33/100

Officers' Casino (lunch):

Building 61

Parking lot:

The parking lot is in the south of the campus behind building 160. Enter through “Westtor”.

Note: All full registrations include a seven-day ticket for the Munich public transport system!



Registration desk hours during the conference:

The registration desk is situated on the ground floor in the lobby of building 33/100.
Opening hours are:

Sunday, May 20 th , 2007:	3:00 pm – 7:00 pm (Note: On Sunday no public bus transport to the university!)
Monday, May 21 st , 2007:	7:30 am – 6:00 pm.
Monday, May 21 st , 2007:	7:00 pm – 9:00 pm (at Welcome Reception).
Tuesday, May 22 nd , 2007:	7:00 am – 6:00 pm.
Wednesday, May 23 rd , 2007:	8:00 am – 7:00 pm.
Thursday, May 24 th , 2007:	8:00 am – 6:00 pm.
Friday, May 25 th , 2007:	8:00 am – 6:00 pm.

Floor plans of the conference building (Building 33/100)

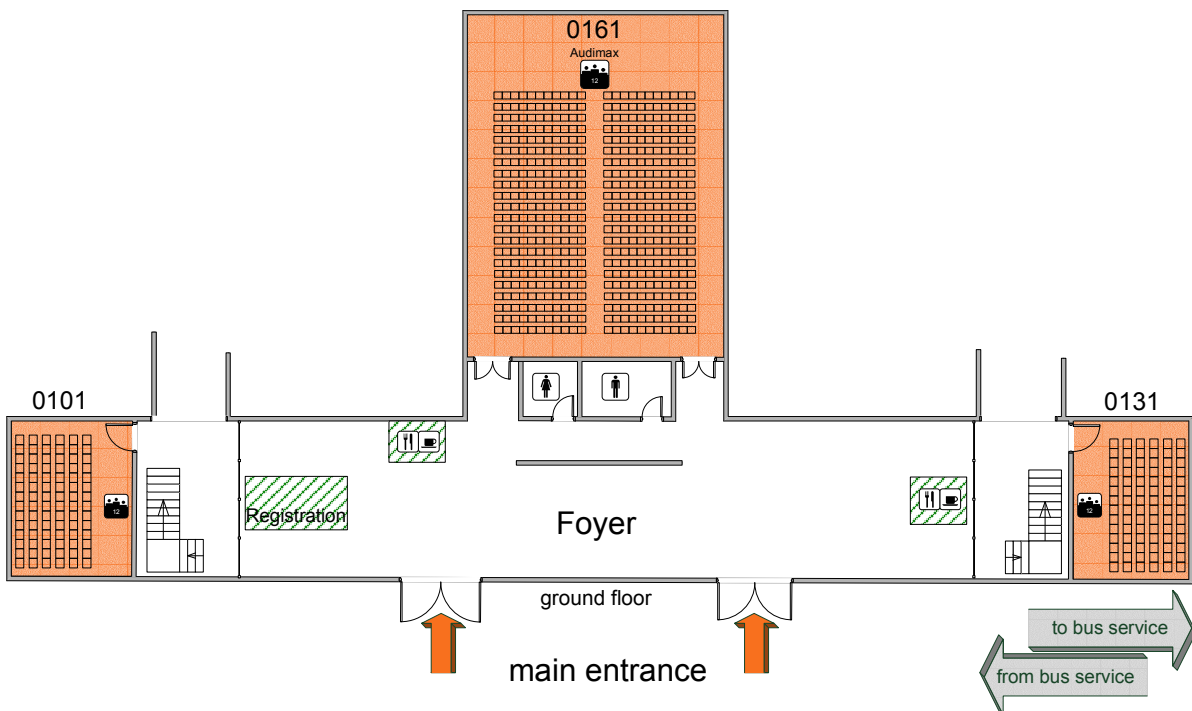
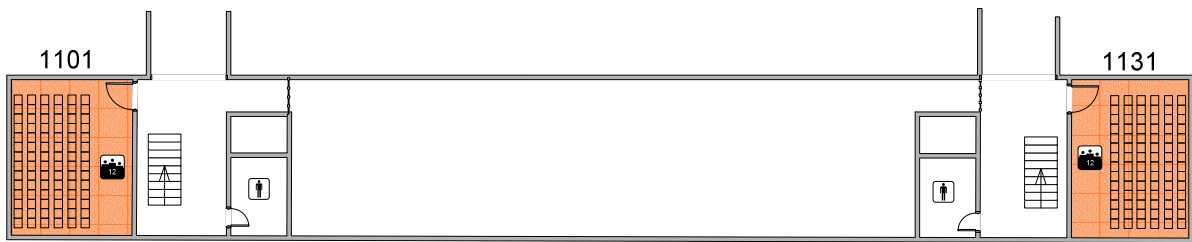
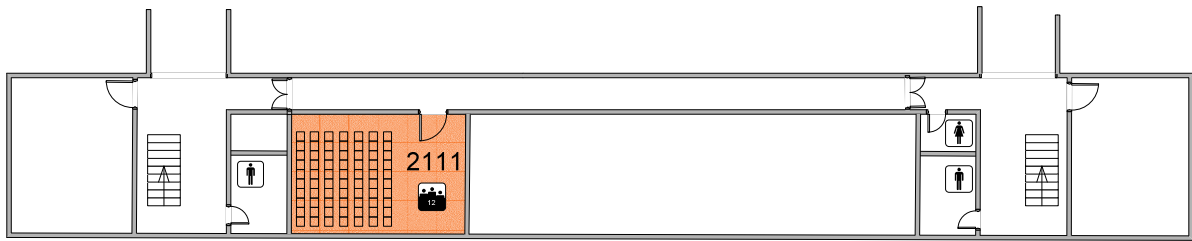
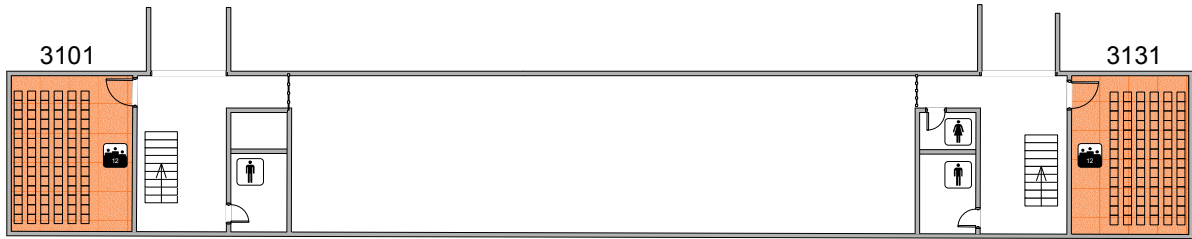

Universität der Bundeswehr München – Campus Map (part I)

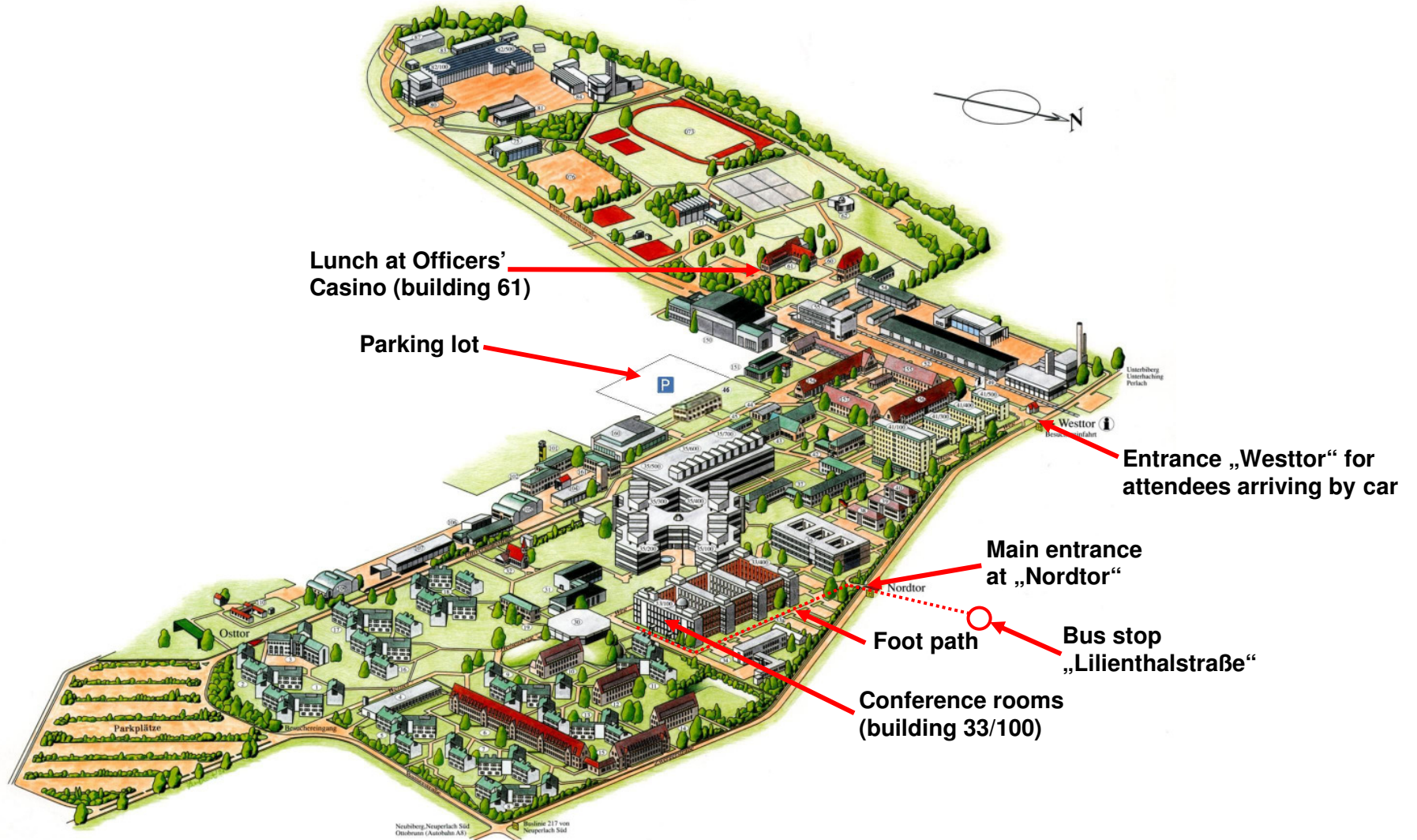

Universität der Bundeswehr München – Campus Map (part II)

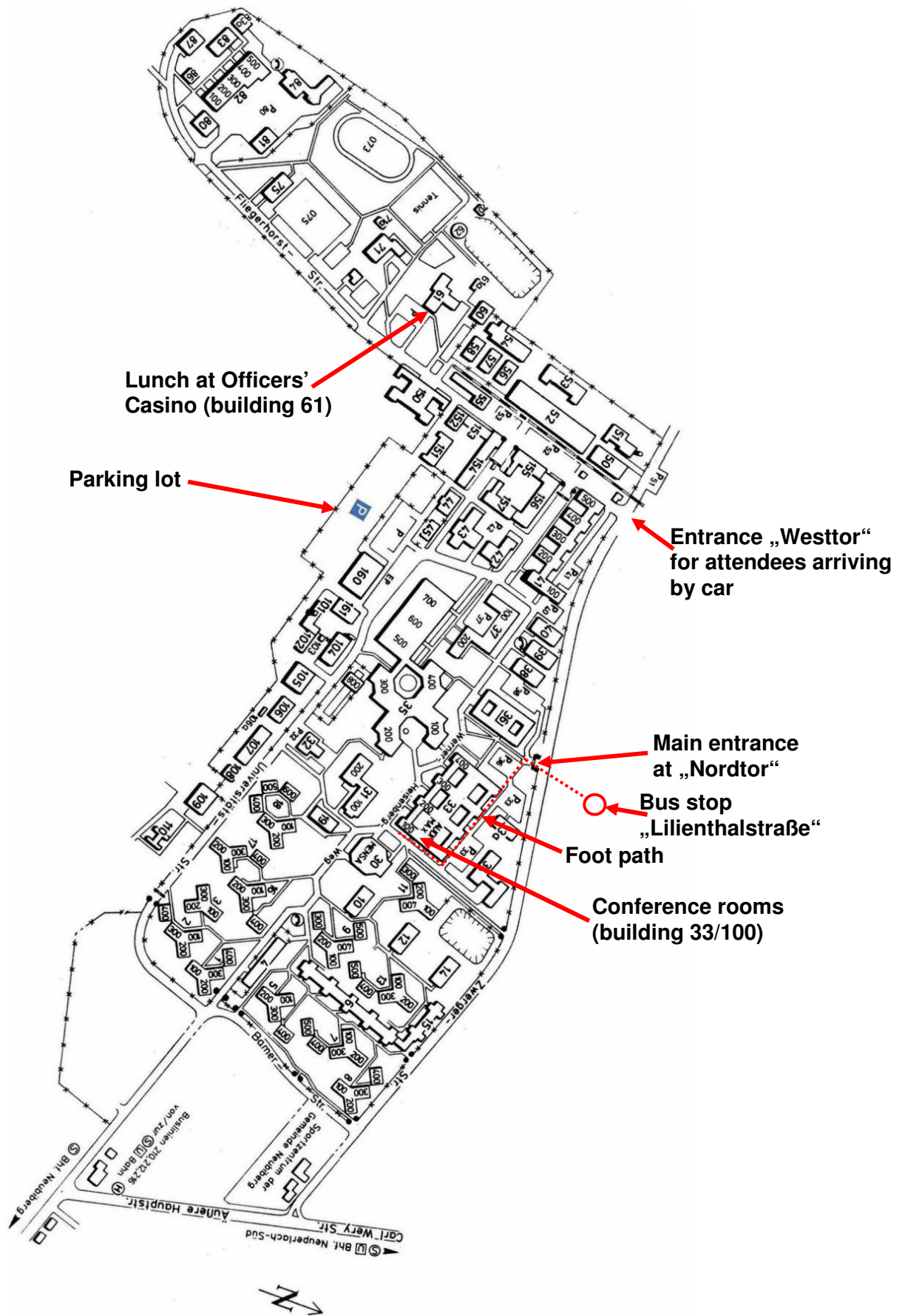

Underground Map of Munich

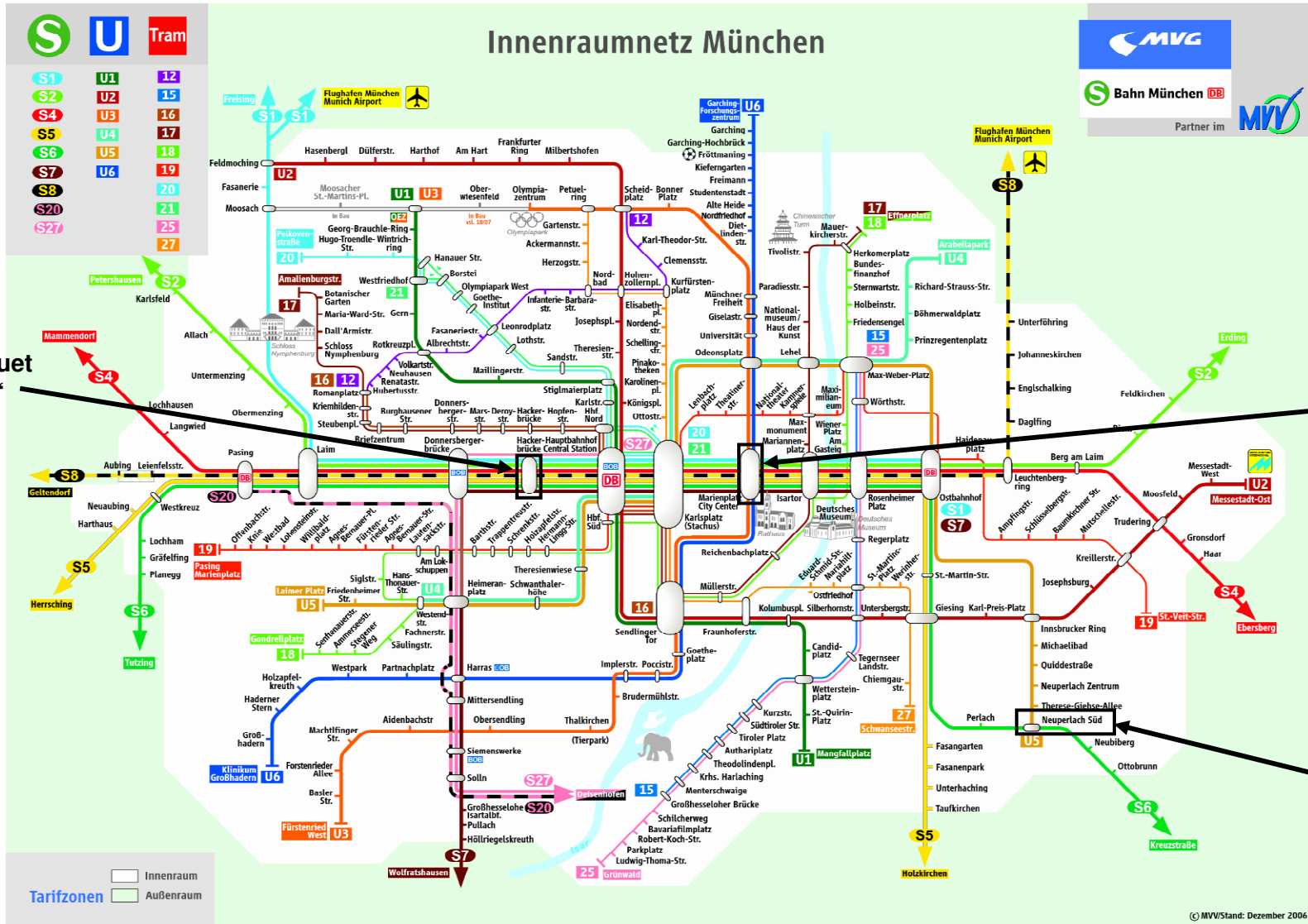

Symposium Banquet at „Hackerbrücke“

Welcome Reception at „Marienplatz“

Station „Neuperlach Süd“

How to find us: Universität der Bundeswehr München – public transport

- 1) Railway/subway to „Neuperlach Süd“ (railway: S6, subway: U5)
Monday-Friday during rush hour: departure every 5 minutes
- 2) Bus to „Lilienthalstraße“ (bus: 217 „Unterhaching“ or 218 „Campeon“)
Monday-Friday during working hour: departure every 10 minutes
- 3) From bus stop short walk to „Nordtor“ – the visitors' entrance to the campus

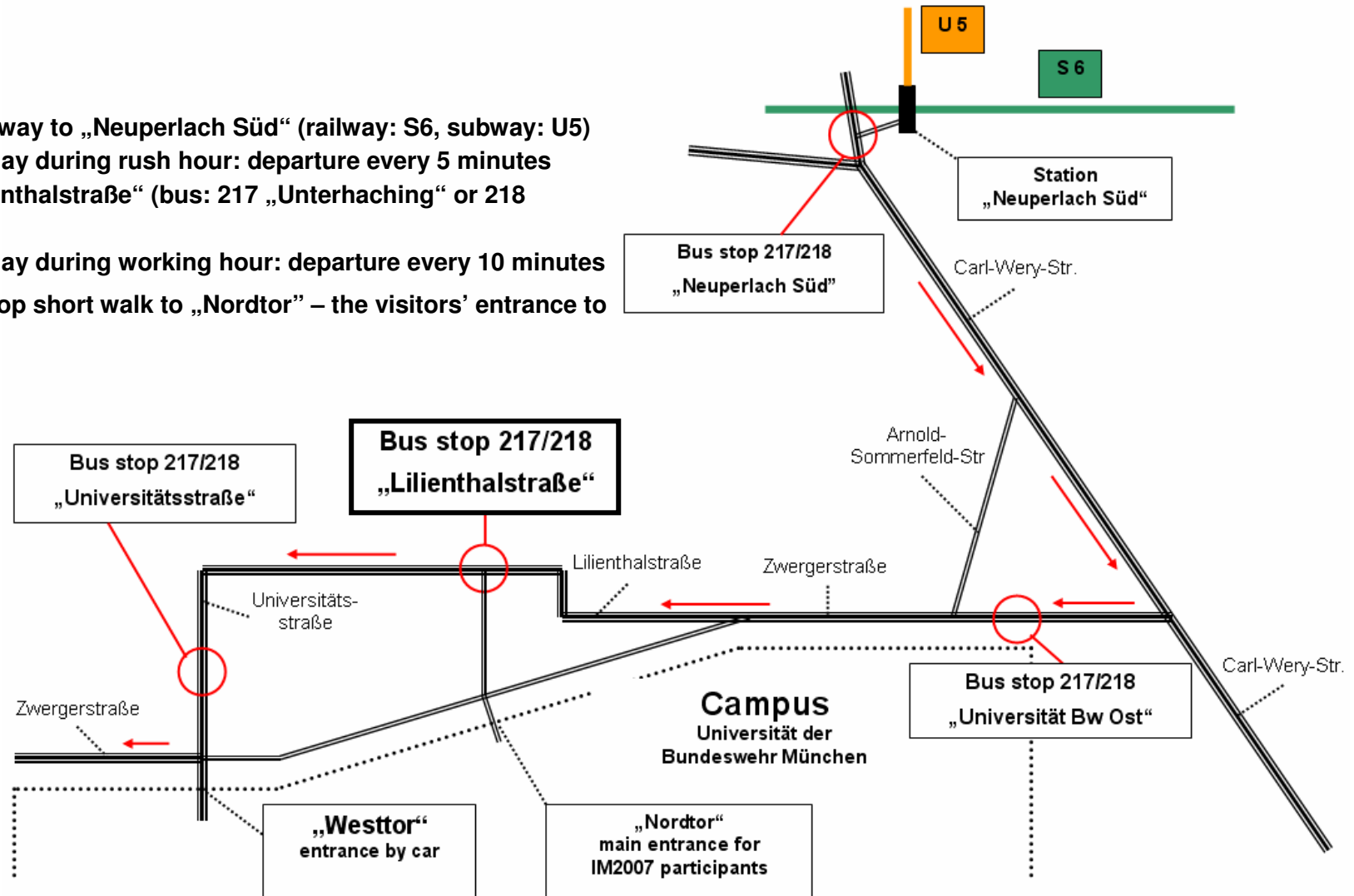

Time table (Bus 217 & 218)

→ „Campeon West“ or „Unterhaching“

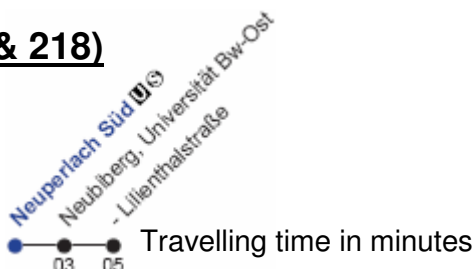

Time	Monday -- Friday						Sunday
5 am							
6 am		16	26	36	46	56	-
7 am	06	16	26	36	46	56	-
8 am	06	16	26	36	46	56	-
9 am	06		26	36	46	56	-
10 am	06	16					-
11 am	06		26	36	46		-
12 pm	06	16	26		46	56	-
1 pm	06			30	40		-
2 pm	00	10	20		40	50	-
3 pm	00		20	30	40	50	-
4 pm	00	10	20	30	40	50	-
5 pm	00	10	20	30	40	50	-
6 pm	00	10	20	30		50	-
7 pm			30				-

→ „Neuperlach Süd“

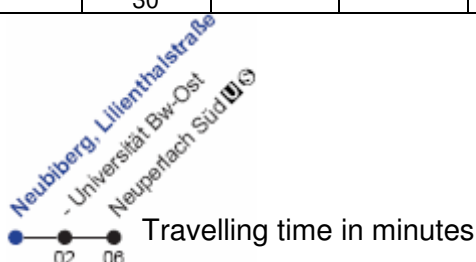

Time	Monday -- Friday						Sunday
5 am							
6 am			20	32	42	52	-
7 am	02	12	22	32	42	52	-
8 am	02	12	22	32	42	52	-
9 am	02	12	22	32		52	-
10 am	02	12		32	42	52	-
11 am		12	22	32		52	-
12 pm	02	12		32	42	52	-
1 pm		12	22	32		57	-
2 pm	07		27	37	47		-
3 pm	07	17	27	37	47	57	-
4 pm	07	17	27	37	47	57	-
5 pm	07	17	27	37	47	57	-
6 pm	07	17	27	37	47	57	-
7 pm		17				57	-

Time table (IM07 shuttle bus)

Day	Neuperlach Süd -> Lilienthalstraße	Lilienthalstraße -> Neuperlach Süd
Tuesday May 22th	7:30 am and 7:50 am	5:55 pm and 6:15 pm
Wednesday May 23th	8:10 am and 8:30 am	5:55 pm and 6:15 pm
Thursday May 24th	8:10 am and 8:30 am	5:15 pm and 5:35 pm

Information regarding public transport

Munich Public Transport's Association's Website: <http://www.mvv-muenchen.de>

A few notes on ticketing

If you stay in Munich, you have basically three options to buy tickets to get to the university. The tickets mentioned below include the following means of transportation: Railway, subway, bus and tram.

1. A one-day-ticket for "München Innenraum", which is valid for all over Munich (white zone) (but not all suburbs) and valid to get to the university. The ticket needs to be validated after buying it and is valid until the next day 4 am.
2. A one-trip-ticket, valid for one way to Neubiberg. It needs say "1 Zone".
3. A multi-ticket, so called "Streifenkarte". It has ten "stripes". For a one-way trip from / to Munich to / from Neubiberg, you need to validate **2 stripes**.

Note: All full registrations include a seven-day ticket for the Munich public transport system!

The probably most flexible, hassle free ticket is the "one-day-ticket". It's currently only 10% more expensive than two one-ways, so it's probably worth getting it. Getting from the airport to the city is more expensive. We strongly recommend using public transport and buying a day ticket "Tageskarte Gesamtnetz" for 10 Euro. A taxi ride is ~ 60 Euro and depending of the time of arrival not faster. To all hotels, you'll prefer the S8 over the S1, because it is quicker. You'll need to change trains at Munich East (Ostbahnhof).

Train station Neuperlach Süd

The university is easily accessible from the suburban and underground train station at "Neuperlach Süd" (subway: U5 to Neuperlach Süd, railway S6 to Aying or Höhenkirchen-Siegertsbrunn). From there it is a 5 minute bus ride (busses 217 to Campeon or 218 to Unterhaching) to the main gate. The stop's name is "Lilienthalstraße" (Lilienthal street). It is the **second stop**. You might ask the driver to assist you, some of them actually speak German, a few English - and again some of them are really helpful. There is a bus every 10 minutes and no need to hurry, if you arrive by train, because the bus will leave just before the train arrives. Although, on your way back to the city be aware that the underground will leave 1-2 minutes after the bus arrived.

How to find us: Universität der Bundeswehr München – arriving by car (part I)

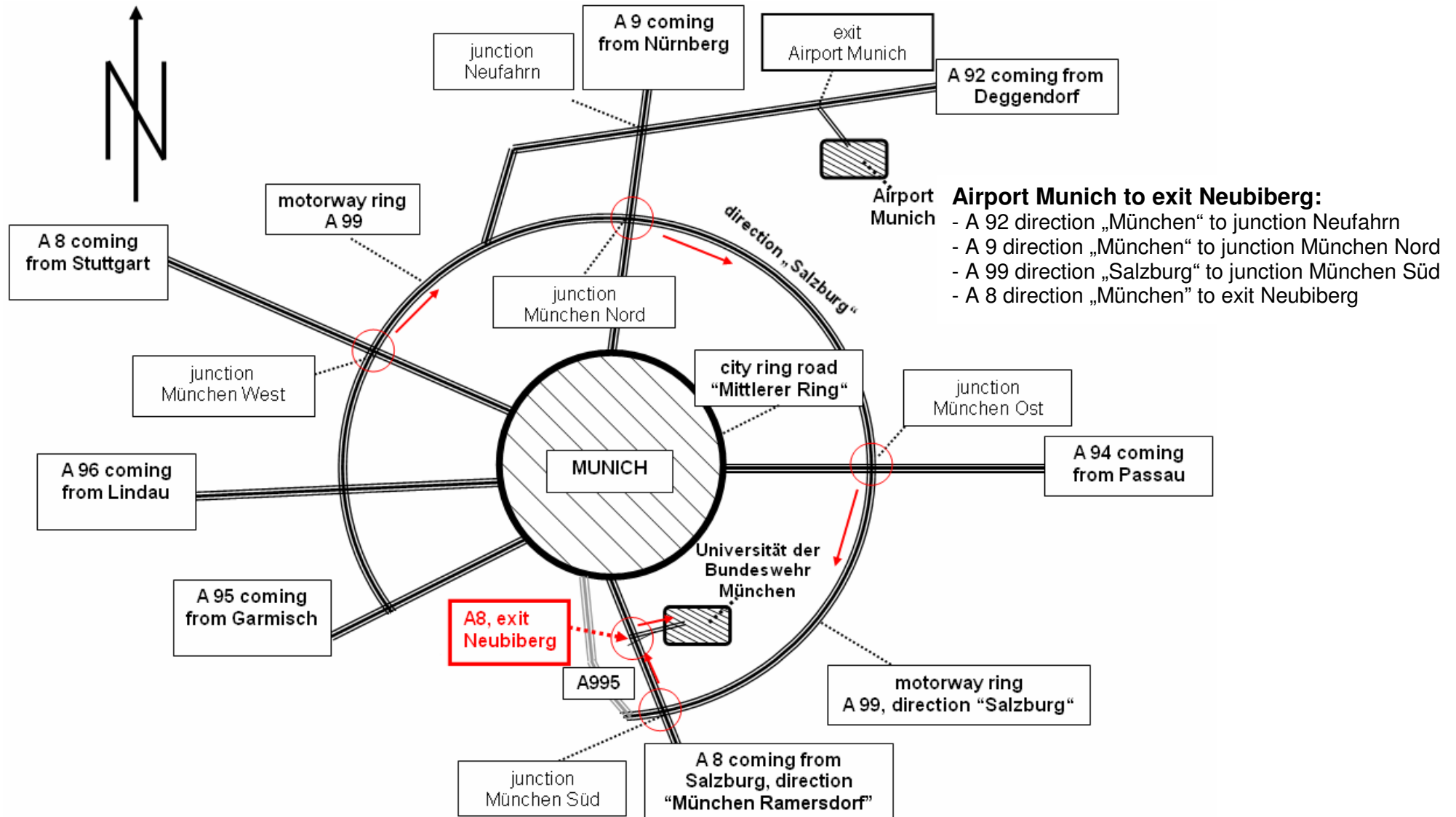

How to find us: Universität der Bundeswehr München – arriving by car (part II)

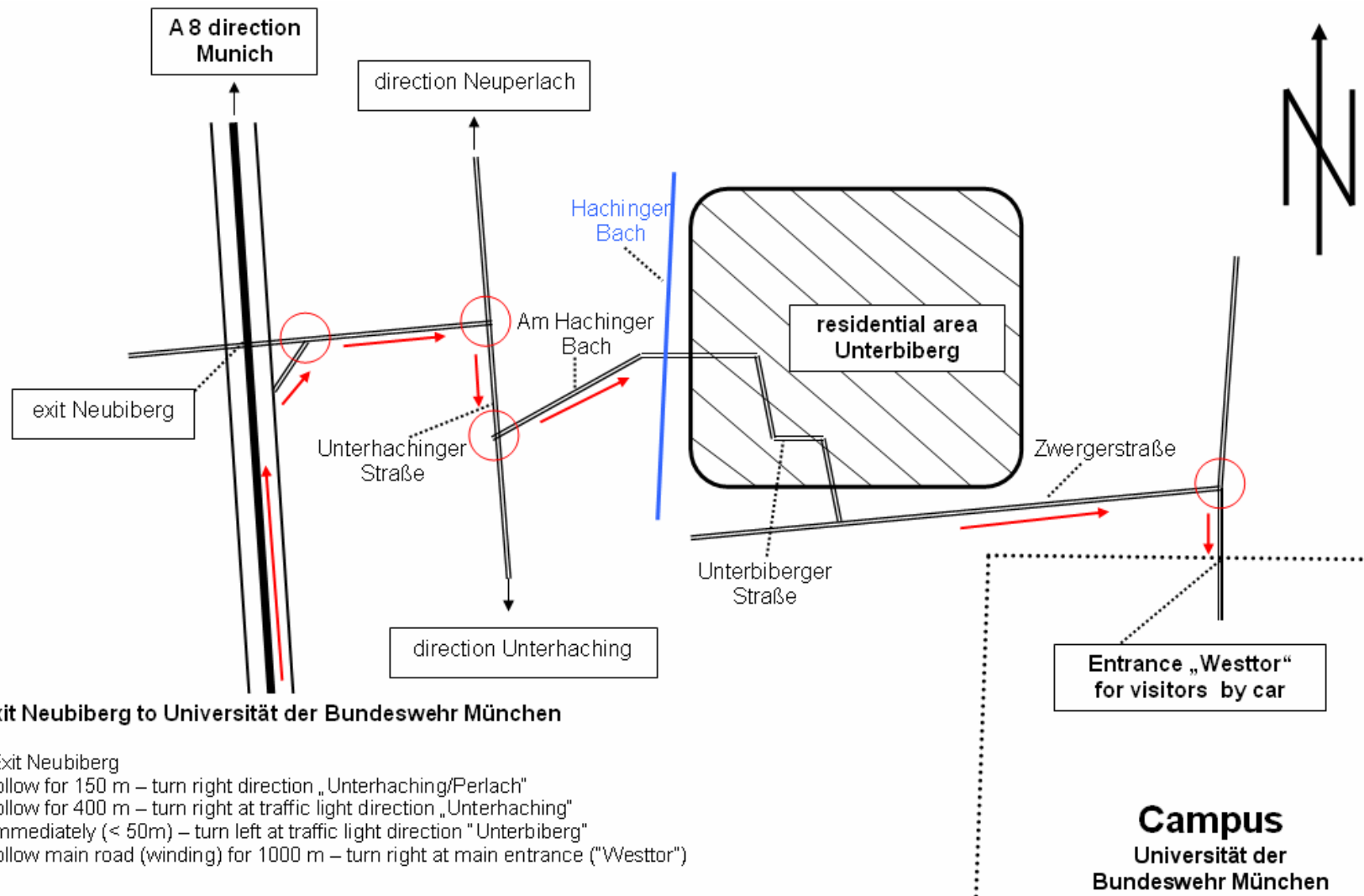

IM 2007
Moving from Bits
to Business Value

21-25 May 2007
Munich, Germany



10th IFIP/IEEE Symposium on Integrated Management

Social Events Schedule

Monday:

Welcome Reception

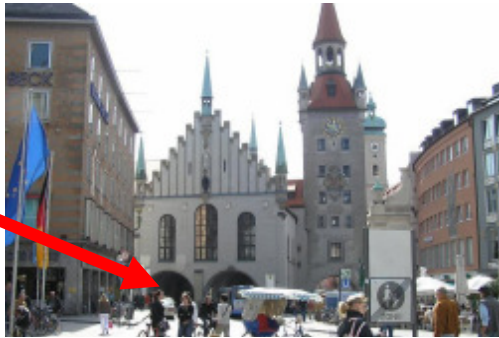

Old City Hall of Munich, Auditorium
Station „Marienplatz“
Start: 7:30 pm
End: 9:30 pm

*At S-Bahn station „Marienplatz“,
follow the signs „Burgstraße“,
on the surface keep straight on,
entrance is in the left archway*

Wednesday:

Symposium Banquet



Augustiner Keller, Munich
Arnulfstraße 52
Start: 7:15 pm
End: 11:45 pm

*At S-Bahn station „Hackerbrücke“
turn North, at Arnulfstraße right
approx. 200m on left-hand side*

!!! THIS IS NOT A TICKET – Please bring your badge with you to get access !!!